

REV	DESCRIPTION	DATE
00	First issue	
Interface		
9BIT-SPI+24BIT-RGB		

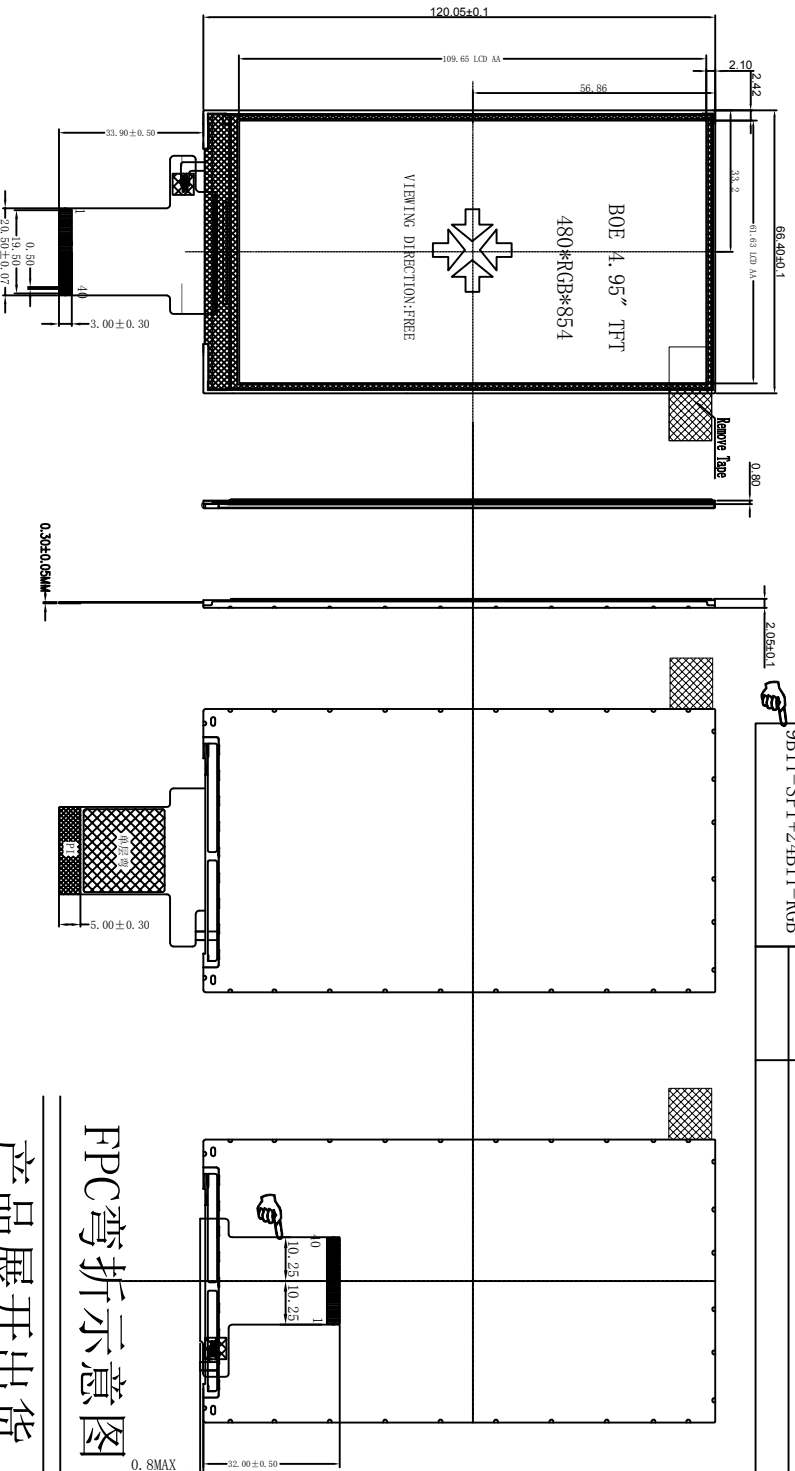

胶铁一体背光

产品展开出货

FPC弯折示意图

BACKLIGHT CIRCUIT

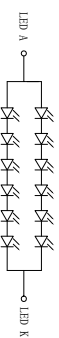

IF=40MA VF=18V-20.4V

- NOTES:
1. DISPLAY TYPE: 4.95", 480*854 TFT LCD
 2. DISPLAY MODE: transmissive Normally Black
 3. VIEWING DIRECTION: ALL O'clock
 4. DRIVER IC: ST7701S
 5. LCM (White 9 AVG 1/9) :
Brightness: TBDcd/m² (TYP)
Uniformity: 80%(MIN)
 6. BACK LIGHT: 12 chip white LEDs IF=40mA, VF=18V-20.4V
 7. OPERATING TEMP: -20° C TO 70° C, STORAGE TEMP: -30° C TO 80° C
 8. * Critical Parameter, () ref Parameter, [] cpk Parameter
Unspecified Tolerances: ±0.20mm
Modification mark:
 9. SUGGESTION: TP window size unilateral increase 0.3~0.5mm than LCM A.A
 10. REQUIREMENTS ENVIRONMENTAL PROTECTION: Rohs

TITLE:	ASSEMBLY	DO NOT SCALE THIS DRAWING, GENERAL TOLERANCE: ±0.2	
PART NO.:	TXW500072B0	MODULE NO.:	
DRAWN BY:	MR Y	DATE:	2019.07.02
CHECKED BY:		DATE:	
APPROVED BY:		DATE:	
PROJECTION:		SCALE: N.T.S	UNIT: mm
SHEET: 1 OF 1			

